

## AXIS F9114-B Main Unit

4-channel modular barebone unit with audio and I/O

This 4-channel barebone main unit offers flexible installation and requires only one video management software (VMS) license. Ideal for emergency vehicles and buses, it features ignition control with controlled shutdown. Axis Edge Vault protects your Axis device ID and simplifies authorization of Axis devices on your network. Furthermore, AXIS Sensor Metrics Dashboard ACAP comes pre-installed in this main unit. The ACAP gathers information from the connected sensor devices and stores the data directly on the main unit SD-card. The built-in accelerometer alerts you if the vehicle deviates from normal movement.

- > **UL recognized component**
- > **Multiple sensor and cable options**
- > **1080p at 30 fps on 4-channels**
- > **Accelerometer, GPS, modbus support**
- > **Built-in cybersecurity with Axis Edge Vault**

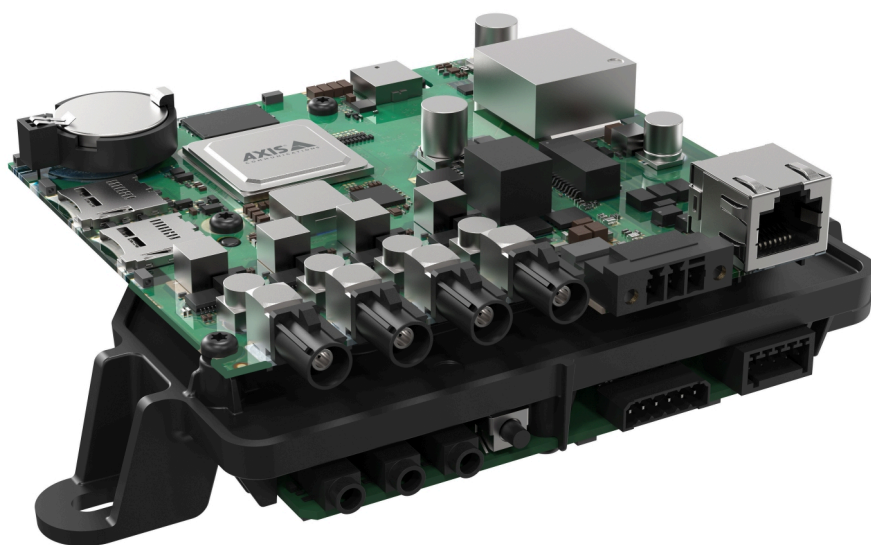

# AXIS F9114-B Main Unit

<b>System on chip (SoC)</b>	
<b>Model</b>	ARTPEC-7
<b>Memory</b>	2x 1024 MB RAM, 512 MB Flash
<b>Video</b>	
<b>Video compression</b>	H.264 (MPEG-4 Part 10/AVC) Baseline, Main and High Profiles H.265 (MPEG-H Part 2/HEVC) Main Profile Motion JPEG
<b>Resolution</b>	1920x1080 HDTV 1080p
<b>Frame rate</b>	Up to 30 fps in 1080p (WDR mode) and up to 60 fps in 720p
<b>Video streaming</b>	Multiple, individually configurable streams in H.264, H.265 and Motion JPEG Axis Zipstream technology in H.264 and H.265 Controllable frame rate and bandwidth VBR/ABR/MBR H.264/H.265 Low latency mode Video streaming indicator
<b>Image settings</b>	Contrast, brightness, sharpness, Forensic WDR, fixed orientation aid, white balance, tone mapping, exposure control, exposure zones, compression, rotation: 0°, 90°, 180°, 270°, mirroring, polygon privacy mask, control queue
<b>Audio</b>	
<b>Audio streaming</b>	Two-way, full duplex
<b>Audio encoding</b>	24bit LPCM, AAC-LC 8/16/32/48 kHz, G.711 PCM 8 kHz, G.726 ADPCM 8 kHz, Opus 8/16/48 kHz Configurable bit rate
<b>Audio input/output</b>	2x external microphone input or line input, 1x line output, ring power, digital audio input
<b>Network</b>	
<b>Network protocols</b>	IPv4, IPv6 USGv6, ICMPv4/ICMPv6, HTTP, HTTPS <sup>a</sup> , HTTP/2, TLS <sup>b</sup> , QoS Layer 3 DiffServ, FTP, SFTP, CIFS/SMB, SMTP, mDNS (Bonjour), UPnP <sup>c</sup> , SNMP v1/v2c/v3 (MIB-II), DNS/DNSv6, DDNS, NTP, NTS, RTSP, RTP, SRTP/RTSPS, TCP, RTCP, DHCP, SSH, SIP, LLDP, CDP, MQTT v3.1.1, Secure syslog (RFC 3164/5424, UDP/TCP/TLS), Link-Local address (ZeroConf)
<b>System integration</b>	
<b>Application Programming Interface</b>	Open API for software integration, including VAPIX <sup>®</sup> and AXIS Camera Application Platform; specifications at <a href="https://axis.com/developer-community">axis.com/developer-community</a> One-click cloud connection ONVIF <sup>®</sup> Profile G and ONVIF <sup>®</sup> Profile S, specification at <a href="https://onvif.org">onvif.org</a>
<b>Event conditions</b>	Device status, digital audio, edge storage, I/O, PTZ, scheduled event, video, MQTT subscribe
<b>Event actions</b>	Play audio clip, toggle I/O, send images, publish MQTT, send notifications, overlay text, recordings, SNMP trap messages, status LED, video clips
<b>Data streaming</b>	Event data
<b>Analytics</b>	
<b>Applications</b>	Included AXIS Video Motion Detection, audio detection AXIS Sensor Metrics Dashboard: GPS over serial: Protocol: NMEA 0183, Port mode: RS232 Modbus over serial: Protocol: Modbus RTU, Port mode: RS485 2-wire Modbus over IP: Protocol: Modbus TCP, Port mode: Ethernet on switch Supported AXIS People Counter Tampering alarm Support for AXIS Camera Application Platform enabling installation of third-party applications, see <a href="https://axis.com/acap">axis.com/acap</a>
<b>AXIS Object Analytics</b>	Object classes: humans, vehicles Scenarios: line crossing, object in area, crossline counting, occupancy in area Up to 10 scenarios Other features: triggered objects visualized with color-coded bounding boxes Polygon include/exclude areas Perspective configuration ONVIF Motion Alarm event

<b>AXIS Scene Metadata</b>	Object classes: humans, faces, vehicles (types: cars, buses, trucks, bikes), license plates Object attributes: confidence, position
<b>Approvals</b>	
<b>Safety</b>	UL recognized component, IS 13252
<b>Network</b>	NIST SP500-267
<b>Cybersecurity</b>	ETSI EN 303 645, BSI IT Security Label
<b>Cybersecurity</b>	
<b>Edge security</b>	<b>Software:</b> Signed OS, brute force delay protection, digest authentication and OAuth 2.0 RFC6749 OpenID Authorization Code Flow for centralized ADFS account management, password protection, AES-XTS-Plain64 256bit SD card encryption <b>Hardware:</b> Axis Edge Vault cybersecurity platform Secure element (CC EAL 6+), Axis device ID, secure keystore, signed video, secure boot
<b>Network security</b>	IEEE 802.1X (EAP-TLS, PEAP-MSCHAPv2) <sup>c</sup> , IEEE 802.1AE (MACsec PSK/EAP-TLS), IEEE 802.1AR, HTTPS/HSTS <sup>d</sup> , TLS v1.2/v1.3 <sup>e</sup> , Network Time Security (NTS), X.509 Certificate PKI, host-based firewall
<b>Documentation</b>	<i>AXIS OS Hardening Guide</i> <i>Axis Vulnerability Management Policy</i> <i>Axis Security Development Model</i> AXIS OS Software Bill of Material (SBOM) To download documents, go to <a href="https://axis.com/support/cybersecurity/resources">axis.com/support/cybersecurity/resources</a> To read more about Axis cybersecurity support, go to <a href="https://axis.com/cybersecurity">axis.com/cybersecurity</a>
<b>General</b>	
<b>Sustainability</b>	PVC free
<b>Power</b>	Power over Ethernet (PoE) IEEE 802.3at Type 2 Class 4 10–48 V DC, typical 9 W, max 25.5 W
<b>Connectors</b>	RJ45 for 10BASE-T/100BASE-TX/1000BASE-T PoE 4x FAKRA for sensor units 6-pin terminal block for 4x configurable I/Os (12 V DC output), max load 50 mA 3.5 mm mic/line in, 3.5 mm line out 5-pin terminal block RS232/RS485 3-pin terminal block for 10–48 V DC input
<b>Storage</b>	Support for microSD/microSDHC/microSDXC card and encryption Recording to network-attached storage (NAS) For SD card and NAS recommendations see <a href="https://axis.com">axis.com</a>
<b>Operating conditions</b>	-40 °C to 60 °C (-40 °F to 140 °F) Humidity 10–85% RH (non-condensing)
<b>Storage conditions</b>	-40 °C to 65 °C (-40 °F to 149 °F) Humidity 5–95% RH (non-condensing)
<b>Dimensions</b>	43 x 123 x 160 mm (1.7 x 4.8 x 6.3 in)
<b>Weight</b>	190 g (0.4 lb)
<b>Required hardware</b>	AXIS TU6004-E Cable, AXIS TU6005 Plenum Cable, AXIS F21 Sensor Unit, AXIS F4105-LRE Dome Sensor, AXIS F7225-RE Pinhole Sensor
<b>Included accessories</b>	Installation guide, Windows <sup>®</sup> decoder 1-user license
<b>Optional accessories</b>	AXIS Surveillance Cards TU6001 Connector 3-pin, TU6008 Connector 5-pin, TU6009 Connector 6-pin For more accessories, see <a href="https://axis.com">axis.com</a>
<b>Video management systems</b>	Compatible with AXIS Camera Station Edge, AXIS Camera Station Pro, AXIS Camera Station 5, and video management software from Axis' partners available at <a href="https://axis.com/vms">axis.com/vms</a> .
<b>Languages</b>	English, German, French, Spanish, Italian, Russian, Simplified Chinese, Japanese, Korean, Portuguese, Polish, Traditional Chinese, Dutch, Czech, Swedish, Finnish, Turkish, Thai, Vietnamese
<b>Warranty</b>	5-year warranty, see <a href="https://axis.com/warranty">axis.com/warranty</a>

a. This product includes software developed by the OpenSSL Project for use in the OpenSSL Toolkit. ([openssl.org](https://openssl.org)), and cryptographic software written by Eric Young ([ey@cryptsoft.com](mailto:ey@cryptsoft.com)).

- b. *This product includes software developed by the OpenSSL Project for use in the OpenSSL Toolkit. (openssl.org), and cryptographic software written by Eric Young (eay@cryptsoft.com).*
- c. *This product includes software developed by the OpenSSL Project for use in the OpenSSL Toolkit. (openssl.org), and cryptographic software written by Eric Young (eay@cryptsoft.com).*

- d. *This product includes software developed by the OpenSSL Project for use in the OpenSSL Toolkit. (openssl.org), and cryptographic software written by Eric Young (eay@cryptsoft.com).*
- e. *This product includes software developed by the OpenSSL Project for use in the OpenSSL Toolkit. (openssl.org), and cryptographic software written by Eric Young (eay@cryptsoft.com).*

# AXIS F9114-B Main Unit

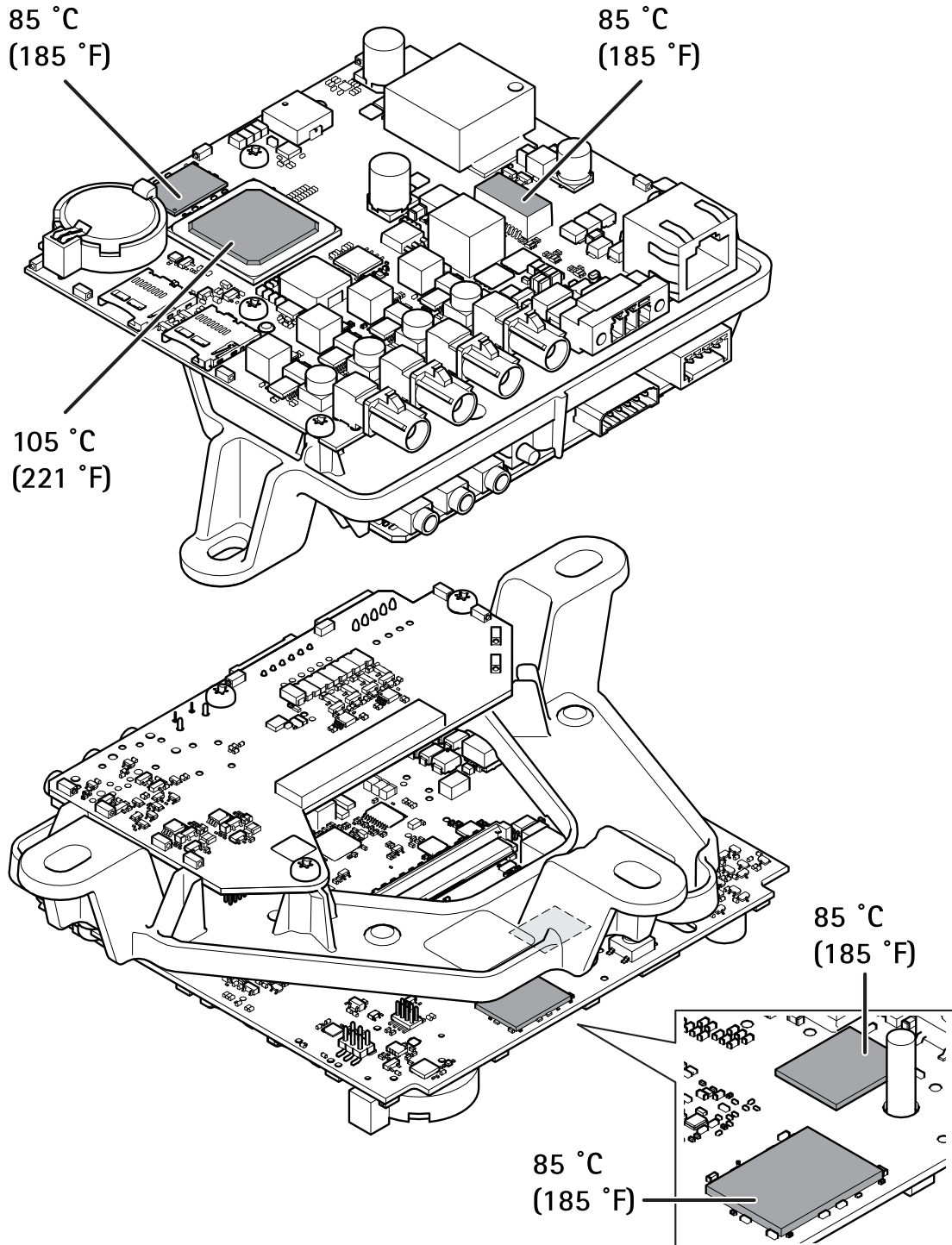

Maximum allowable temperatures. If the ambient temperature is 35 °C (95 °F) or higher, the temperature of the components increases and they must be cooled.