

AXIS TQ1818-E Positioning Unit

Ultra-smooth and high accuracy absolute positioning

AXIS TQ1818-E is a highly responsive and reliable positioning unit, designed for both high-speed and ultra-slow, jerk-free pan and tilt movements. Selected Axis box cameras and thermal cameras can be mounted on the positioning unit. When column-mounted, it enables a 360° unobstructed field of view for the camera and a ground-to-sky view of 135°. Reliable and robust, AXIS TQ1818-E is easy to mount in a variety of ways, thanks to optional mounts for wall and pole installations. The positioning unit includes both RJ45 and SFP interfaces, enabling a long-distance fiber-optic connection with a failover network link.

- > **Responsive positioning with 360° endless pan and 135° tilt from ground to sky**
- > **Long-distance network connection**
- > **Power: 56 V AC or DC**
- > **Weather protection**
- > **For selected Axis box and thermal cameras**



AXIS TQ1818-E Positioning Unit

Approvals

Product markings

UL/cUL, CE, KC, VCCI, RCM

Supply chain

TAA compliant

EMC

CISPR 35, CISPR 32 Class A, EN 55035,
EN 55032 Class A, EN 50121-4, EN 61000-6-1,
EN 61000-6-2
Australia/New Zealand: RCM AS/NZS CISPR 32 Class A
Canada: ICES(A)/NMB(A)
Japan: VCCI Class A
Korea: KS C 9835, KS C 9832 Class A
USA: FCC Part 15 Subpart B Class A
Railway: IEC 62236-4

Safety

CAN/CSA C22.2 No. 62368-1 ed. 3,
IEC/EN/UL 62368-1 ed. 3

Environment

IEC 60068-2-1, IEC 60068-2-2, IEC 60068-2-6,
IEC 60068-2-14, IEC 60068-2-27, IEC 60068-2-78,
IEC/EN 60529 IP66, IEC/EN 62262 IK10, NEMA 250
Type 4X, NEMA TS 2 (2.2.7-2.2.9),
ISO 12944-6:2018 C5 (High), MIL-STD-810H
(Method 501.7, 502.7, 505.7 506.6, 507.6, 509.7, 521.4)

General

Supported products

Selected Axis fixed box cameras, see the product page
at axis.com.

Pan/Tilt

Pan: 360° endless, 0.05°/s to 120°/s
Tilt: -90° to +45°, 0.05°/s to 60°/s
Jerk-free movements at low speed: $\pm 0.01^\circ/\text{s}$ (at 0.05°/s)
De-icing control¹
Dynamic load balancing²

Maximum load

5 kg (11 lb)

Casing

IP66-, NEMA 4X- and IK10-rated
Aluminum casing
Color: white NCS S 1002-B
For repainting instructions, go to the product's support
page. For information about the impact on warranty, go
to axis.com/warranty-implication-when-repainting.

Power

52–58 VDC, typical 17 W, max 150 W

Connectors

Audio: 3.5 mm mic/line in
I/O: 6-pin 2.5 mm terminal block for 4 configurable
inputs/outputs
Network: Shielded RJ45 10BASE-T/100BASE-TX/
1000BASE-T, SFP slot (SFP module not included)³
Power: DC input, terminal block
Illumination (in upper part of positioning unit)

Operating conditions

-40 °C to 60 °C (-40 °F to 140 °F)
Maximum temperature (intermittent): 65 °C (149 °F)
Start-up temperature: -40 °C (-40 °F)
Humidity 10–100% RH (condensing)

Storage conditions

Temperature: -40 °C to 65 °C (-40 °F to 149 °F)
Humidity: 5–95% RH (non-condensing)

Dimensions

For the overall product dimensions, see the dimension
drawing in this datasheet.
Effective Projected Area (EPA): 0.0813 m² (0.088 ft²)

Weight

Without camera
10.5 kg (23 lb)

Box content

Positioning unit, installation guide, connector kit

1. Internal heaters to defrost ice build-up, activated by HTTP API (VAPIX).
2. Pan and tilt motors actively compensate for changes in load conditions induced by external forces such as high winds. This allows minimum power consumption at low wind.
3. If a network link is established via both the SFP slot and the RJ45 connector, the former acts as the primary link and the latter as the fail-over link.

Optional accessories

AXIS T94J01A Wall Mount, AXIS T94N01G Pole Mount, AXIS T95A64 Corner Bracket AXIS Cable 24 V DC/24-240 V AC 22 m, AXIS T8611 SFP Module LC.LX, AXIS T8612 SFP Module LC.SX, Power supply DIN PS56 480 W

For more accessories, go to axis.com/products/axis-tq1818-e-positioning-unit#compatible-products

System tools

Accessory selector

Available at axis.com

Warranty

5-year warranty, see axis.com/warranty

Part numbers

Available at axis.com/products/axis-tq1818-e-positioning-unit#part-numbers

Sustainability

Substance control

PVC free, BFR/CFR free in accordance with JEDEC/ECA Standard JS709

RoHS in accordance with EU RoHS Directive 2011/65/EU and 2015/863, and standard EN IEC 63000:2018

REACH in accordance with (EC) No 1907/2006. For SCIP UUID, see echa.europa.eu

Materials

Renewable carbon-based plastic content: 12% (bio-based)

Screened for conflict minerals in accordance with OECD guidelines

To read more about sustainability at Axis, go to axis.com/about-axis/sustainability

Environmental responsibility

axis.com/environmental-responsibility

Axis Communications is a signatory of the UN Global Compact, read more at unglobalcompact.org

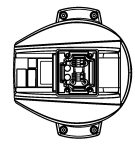
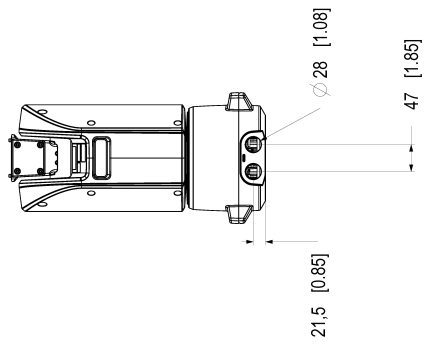
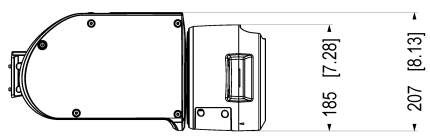
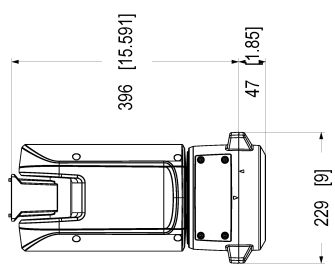
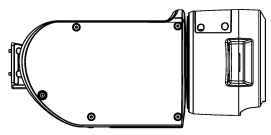
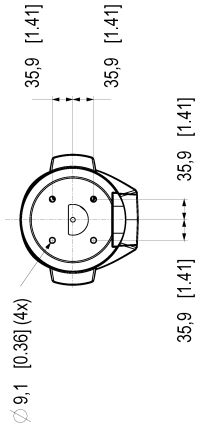
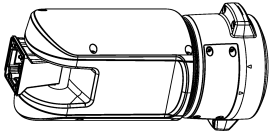

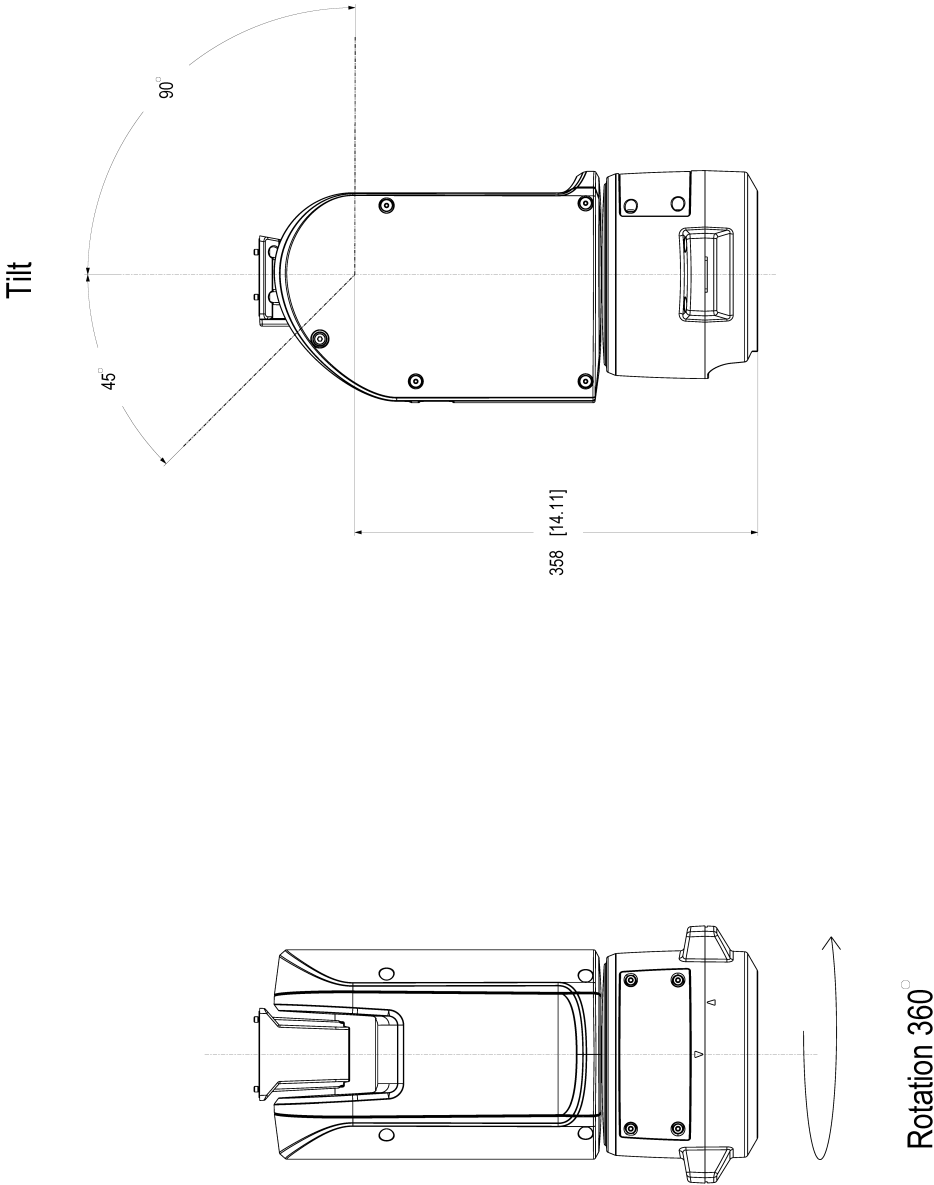

Dimensions in mm (inch)

Year	Model	Weight
2025 Feb-14	M4.1	12
2025 Feb-14	M4.1	12
2025 Feb-14	M4.1	12

AXIS TQ1818-E Positioning Unit

