

AXIS F9114-B Main Unit

4-channel modular barebone unit with audio and I/O

This 4-channel barebone main unit offers flexible installation and requires only one video management software (VMS) license. Ideal for emergency vehicles and buses, it features ignition control with controlled shutdown. Axis Edge Vault protects your Axis device ID and simplifies authorization of Axis devices on your network. Furthermore, AXIS Sensor Metrics Dashboard ACAP comes pre-installed in this main unit. The ACAP gathers information from the connected sensor devices and stores the data directly on the main unit SD-card. The built-in accelerometer alerts you if the vehicle deviates from normal movement.

- > **UL recognized component**
- > **Multiple sensor and cable options**
- > **1080p at 30 fps on 4-channels**
- > **Accelerometer, GPS, modbus support**
- > **Built-in cybersecurity with Axis Edge Vault**

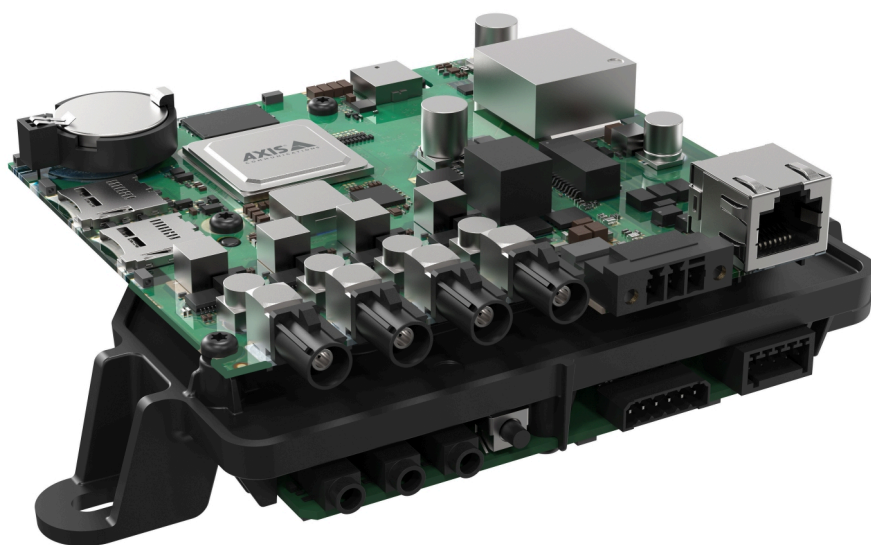

AXIS F9114-B Main Unit

System on chip (SoC)

Model	ARTPEC-7
Memory	2x 1024 MB RAM, 512 MB Flash

Video

Video compression	H.264 (MPEG-4 Part 10/AVC) Baseline, Main and High Profiles H.265 (MPEG-H Part 2/HEVC) Main Profile Motion JPEG
Resolution	1920x1080 HDTV 1080p
Frame rate	Up to 30 fps in 1080p (WDR mode) and up to 60 fps in 720p
Video streaming	Multiple, individually configurable streams in H.264, H.265 and Motion JPEG Axis Zipstream technology in H.264 and H.265 Controllable frame rate and bandwidth VBR/ABR/MBR H.264/H.265 Low latency mode Video streaming indicator
Image settings	Contrast, brightness, sharpness, Forensic WDR, fixed orientation aid, white balance, tone mapping, exposure control, exposure zones, compression, rotation: 0°, 90°, 180°, 270°, mirroring, polygon privacy mask, control queue

Audio

Audio streaming	Two-way, full duplex
Audio encoding	24bit LPCM, AAC-LC 8/16/32/48 kHz, G.711 PCM 8 kHz, G.726 ADPCM 8 kHz, Opus 8/16/48 kHz Configurable bit rate
Audio input/output	2x external microphone input or line input, 1x line output, ring power, digital audio input

Network

Network protocols	IPv4, IPv6 USGv6, ICMPv4/ICMPv6, HTTP, HTTPS, HTTP/2, TLS, QoS Layer 3 DiffServ, FTP, SFTP, CIFS/SMB, SMTP, mDNS (Bonjour), UPnP®, SNMP v1/v2c/v3 (MIB-II), DNS/DNSv6, DDNS, NTP, NTS, RTSP, RTP, SRTP/RTSPS, TCP, RTCP, DHCP, SSH, SIP, LLDP, CDP, MQTT v3.1.1, Secure syslog (RFC 3164/5424, UDP/TCP/TLS), Link-Local address (ZeroConf)
--------------------------	--

System integration

Application Programming Interface	Open API for software integration, including VAPIX® and AXIS Camera Application Platform; specifications at axis.com/developer-community One-click cloud connection ONVIF® Profile G and ONVIF® Profile S, specification at onvif.org
Event conditions	Device status, digital audio, edge storage, I/O, PTZ, scheduled event, video, MQTT subscribe
Event actions	Play audio clip, toggle I/O, send images, publish MQTT, send notifications, overlay text, recordings, SNMP trap messages, status LED, video clips
Data streaming	Event data
Analytics	
Applications	Included AXIS Video Motion Detection, audio detection AXIS Sensor Metrics Dashboard: GPS over serial: Protocol: NMEA 0183, Port mode: RS232 Modbus over serial: Protocol: Modbus RTU, Port mode: RS485 2-wire Modbus over IP: Protocol: Modbus TCP, Port mode: Ethernet on switch Supported AXIS People Counter Tampering alarm Support for AXIS Camera Application Platform enabling installation of third-party applications, see axis.com/acap
AXIS Object Analytics	Object classes: humans, vehicles Scenarios: line crossing, object in area, crossline counting, occupancy in area Up to 10 scenarios Other features: triggered objects visualized with color-coded bounding boxes Polygon include/exclude areas Perspective configuration

ONVIF Motion Alarm event

AXIS Scene Metadata	Object classes: humans, faces, vehicles (types: cars, buses, trucks, bikes), license plates Object attributes: confidence, position
----------------------------	--

Approvals

Safety	UL recognized component, IS 13252
Network	NIST SP500-267
Cybersecurity	ETSI EN 303 645

Cybersecurity

Edge security	Software: Signed OS, brute force delay protection, digest authentication and OAuth 2.0 RFC6749 OpenID Authorization Code Flow for centralized ADFS account management, password protection, AES-XTS-Plain64 256bit SD card encryption Hardware: Axis Edge Vault cybersecurity platform Secure element (CC EAL 6+), Axis device ID, secure keystore, signed video, secure boot
Network security	IEEE 802.1X (EAP-TLS, PEAP-MSCHAPv2), IEEE 802.1AE (MACsec PSK/EAP-TLS), IEEE 802.1AR, HTTPS/HSTS, TLS v1.2/v1.3, Network Time Security (NTS), X.509 Certificate PKI, host-based firewall

Documentation

AXIS OS Hardening Guide
Axis Vulnerability Management Policy
Axis Security Development Model
AXIS OS Software Bill of Material (SBOM)
To download documents, go to axis.com/support/cybersecurity/resources
To read more about Axis cybersecurity support, go to axis.com/cybersecurity

General

Sustainability	PVC free
Power	Power over Ethernet (PoE) IEEE 802.3at Type 2 Class 4 10–48 V DC, typical 9 W, max 25.5 W
Connectors	RJ45 for 10BASE-T/100BASE-TX/1000BASE-T PoE 4x FAKRA for sensor units 6-pin terminal block for 4x configurable I/Os (12 V DC output), max load 50 mA 3.5 mm mic/line in, 3.5 mm line out 5-pin terminal block RS232/RS485 3-pin terminal block for 10–48 V DC input
Storage	Support for microSD/microSDHC/microSDXC card and encryption Recording to network-attached storage (NAS) For SD card and NAS recommendations see axis.com
Operating conditions	-40 °C to 60 °C (-40 °F to 140 °F) Humidity 10–85% RH (non-condensing)
Storage conditions	-40 °C to 65 °C (-40 °F to 149 °F) Humidity 5–95% RH (non-condensing)
Dimensions	43 x 123 x 160 mm (1.7 x 4.8 x 6.3 in)
Weight	190 g (0.4 lb)
Required hardware	AXIS TU6004-E Cable, AXIS TU6005 Plenum Cable, AXIS F21 Sensor Unit, AXIS F4105-LRE Dome Sensor, AXIS F7225-RE Pinhole Sensor
Included accessories	Installation guide, Windows® decoder 1-user license
Optional accessories	AXIS Surveillance Cards TU6001 Connector 3-pin, TU6008 Connector 5-pin, TU6009 Connector 6-pin For more accessories, see axis.com
Video management systems	Compatible with AXIS Camera Station Edge, AXIS Camera Station Pro, AXIS Camera Station 5, and video management software from Axis' partners available at axis.com/vms .
Languages	English, German, French, Spanish, Italian, Russian, Simplified Chinese, Japanese, Korean, Portuguese, Polish, Traditional Chinese, Dutch, Czech, Swedish, Finnish, Turkish, Thai, Vietnamese
Warranty	5-year warranty, see axis.com/warranty

AXIS F9114-B Main Unit

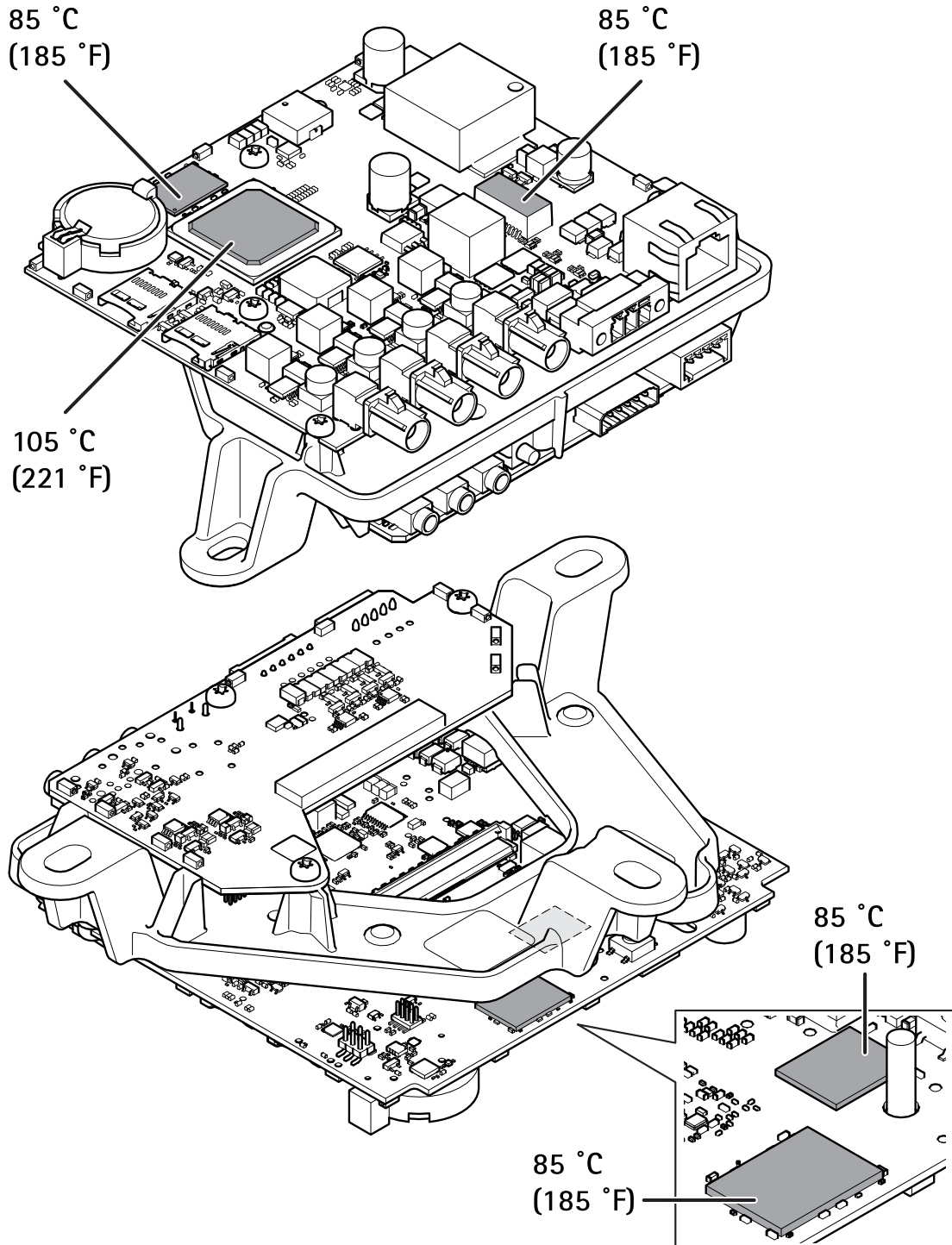

Maximum allowable temperatures. If the ambient temperature is 35 °C (95 °F) or higher, the temperature of the components increases and they must be cooled.