

HOW TO configure Active Directory.

How to configure Active Directory in
AXIS Camera Station for access control

Contents

Introduction	3
Step 1 – Adding Mapping	3
Selecting Groups	4
Step 2 – Synching & making edits	6
Synching and making edits	6
Considerations and limitations	9

Introduction

This document will show you how to configure Active Directory mapping to be used to import your cardholders for access control. And how to manage the users once imported into the system.

Prerequisites

AXIS Camera Station 6.1 or higher

Please note that Axis doesn't take any responsibility for how this configuration may affect your system. If the modification fails or if you get other unexpected results, you may have to restore the settings to default.

Step 1 – Adding Mapping

From the configuration tab under the section “Access control” will be the page “Active Directory Settings” following the steps you will map the synced AD groups and how the data should be imported.

Selecting Groups

Follow these steps to select the groups from Active Directory to be imported:

1. In Axis Camera Station open the configuration tab via the “+” symbol found at the top of the screen.
2. Expand the section “Access control” and click on “Active Directory settings
3. Top left of the page select “Set up import” a new pop-up will appear showing the 3 steps.

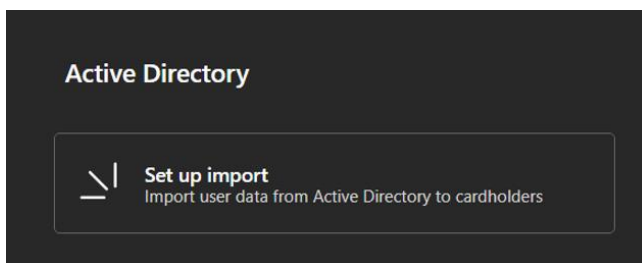

4. Step 1 is to select the is to select the “template user, this user will be used to set up the mapping for fields coming in from Active Directory and how the data should be mapped within the cardholders, once selected press “Next”

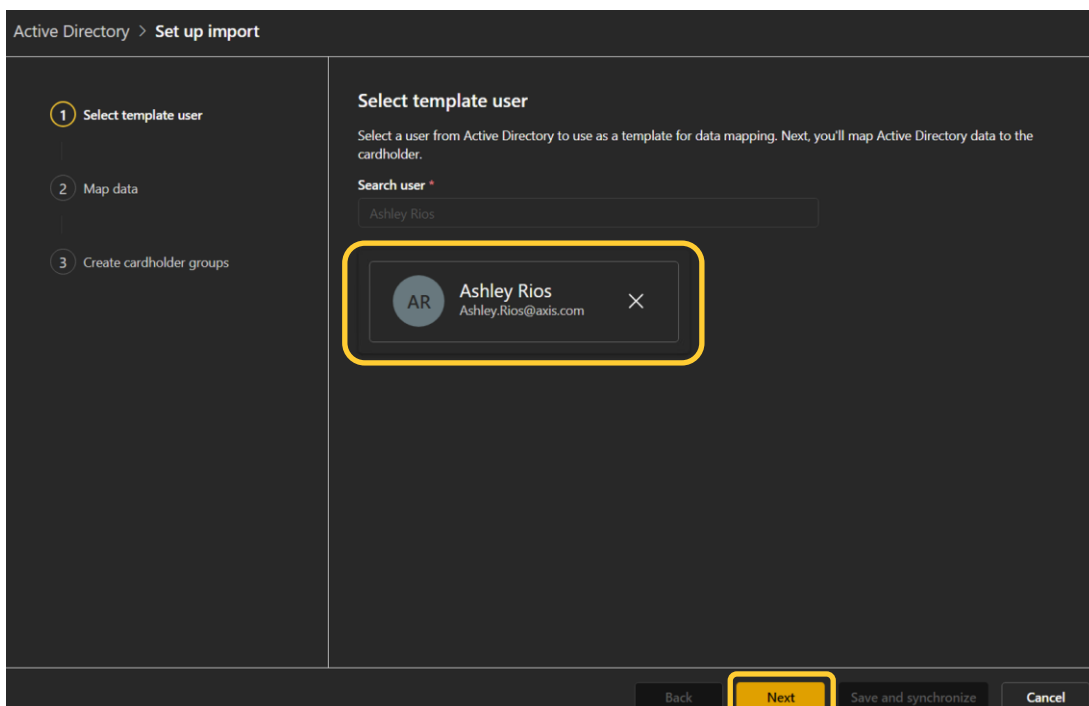

- Step 2 is to map the Active Directory data fields to how they should be shown or used in the added cardholders, to be able to complete the mapping the “Unique identifier”, “First name” and “Last name” are required fields.

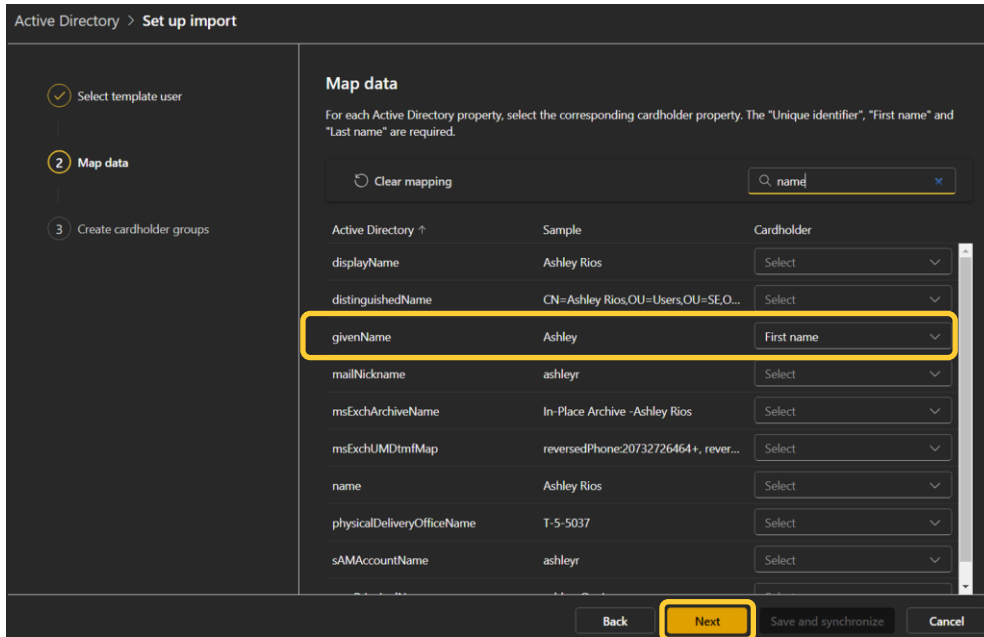

- Step 3 is to create groups within Secure Entry and decide what groups from Active Directory should be synced into these groups, multiple Active Directory groups can be added to a single cardholder group.

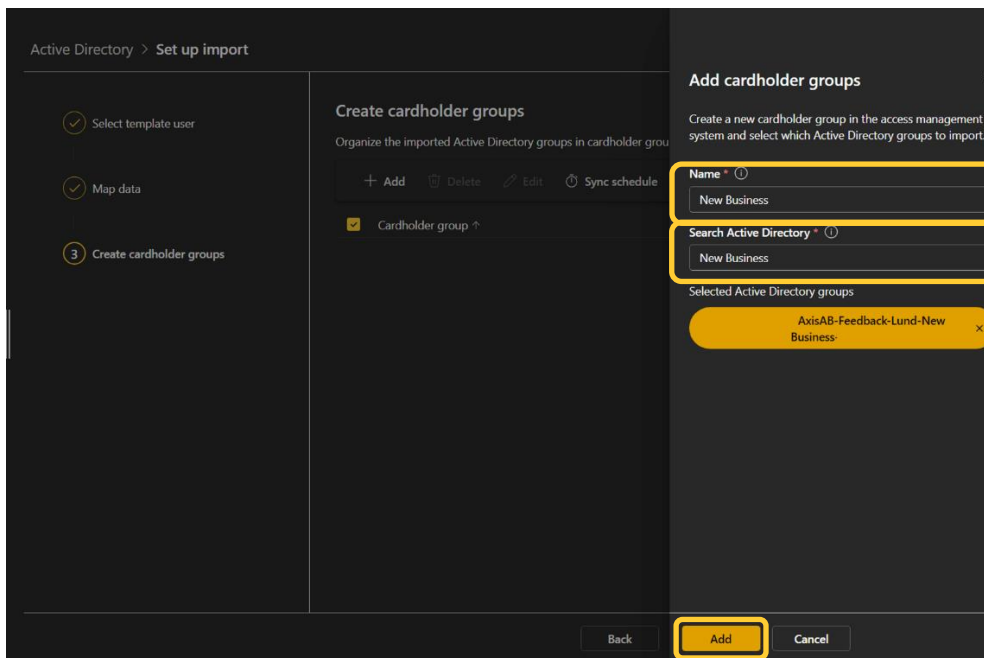

- Once all the group mapping is complete, you can click “Save and synchronize”

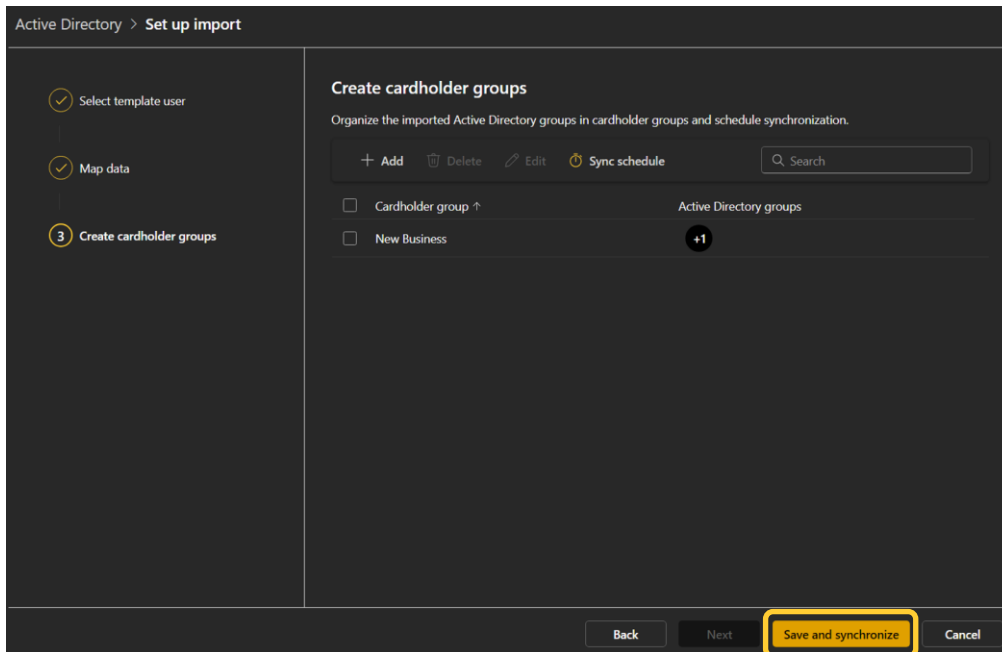

Step 2 – Synching & making edits

Now the Mapping has been completed, all users will be imported to be configured with Access rules and other settings.

Synching and making edits

Follow these steps to select view AD created cardholders, and how to make changes to them:

- In Axis Camera Station open the configuration tab via the “+” symbol found at the top of the screen.
- Expand the section “Access control” and click on “Active Directory settings” and cardholder groups

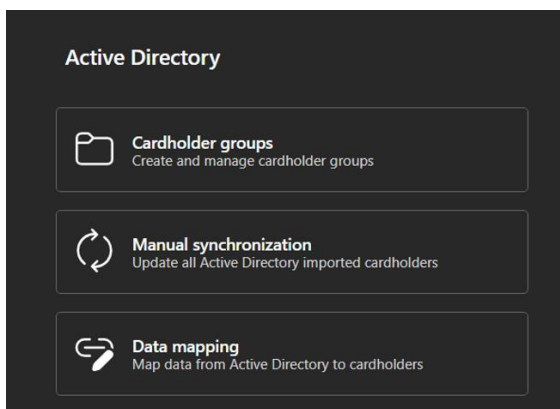

- Here you will see the mapping made in the previous steps, the last sync performed and when the next scheduled sync is.

Active Directory > Cardholder groups

Save Save and synchronize

Create cardholder groups

Organize the imported Active Directory groups in cardholder groups and schedule synchronization.

+ Add Delete Edit Sync schedule Search

<input type="checkbox"/> Cardholder group ↑	Active Directory groups	Size	Last sync	Next sync
<input type="checkbox"/> New Business	+1	1 / 1	2024-12-03, 13:07:36	

- To configure the next sync press the “Sync schedule Button” in the side panel you will be given 4 options, Hourly/Daily/Weekly/Manual. Select the one you wish to use. (A manual sync can always be done from the Active Directory Settings landing page regardless of the option chosen)

Scheduled synchronization

Select how often you want to synchronize Active Directory with the access management system for all cardholder groups.

Hourly (on the hour)

Daily (at 00:00)

Weekly (at 00:00 Monday)

Manual

5. From the top of the page select the “+” symbol and open “Access Management”, here you will see all the imported cardholders from the AD mapping. These cardholders can then be added to your access rules, or via groups, the created group can be added to an access rule. Note that any cardholders created by the AD import will have a bubble stating “Active Directory”

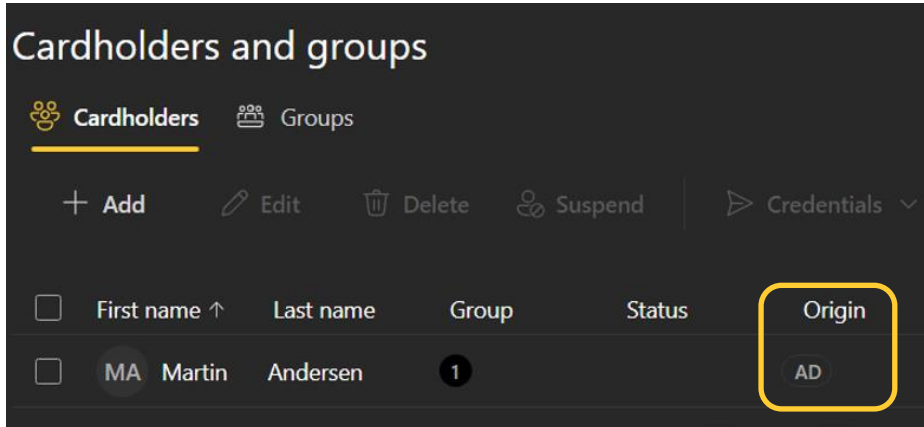

Considerations and limitations

- First name, last name and unique identifier are base requirements to import cardholders
- Editing of cardholder only allows to add additional credentials, security features are not currently supported
- Any changes made require a manual sync in the Active Directory mapping page